

# basic wire and cable

3900 N. ROCKWELL ST. CHICAGO, IL 60618-3719, TEL: (773) 539-1800, FAX: (773) 539-3500

M  
A  
N  
U  
F  
A  
C  
T  
U  
R  
I  
N  
G  
  
C  
A  
P  
A  
B  
I  
L  
I  
T  
I  
E  
S

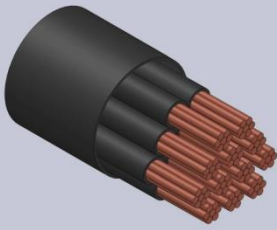

## CONDUCTOR TYPES

- AWG Sizes 24 to 3360MCM
- Solid or Stranded
- Bare Copper, Tinned Copper, Silver and Nickel Coated Copper, Aluminum

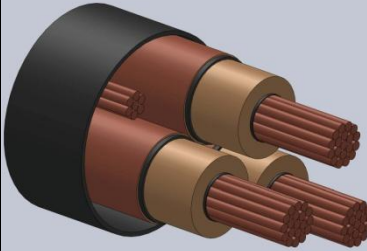

## INSULATION AND JACKETING

- XLP, PVC, TPE, LSZH, CPE, CSPE, PE
- Insulation O.D: Up to 4.0"
- Jacket O.D: Up to 4.5"

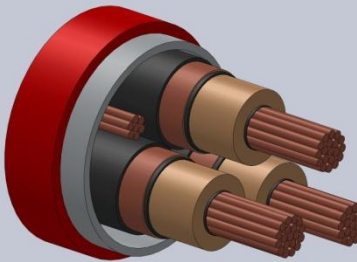

## CABLING

- Single Conductors, Pairs/Triads Multi-Conductor & Composite
- Non-Shielded or Shielded,
- Individual or Overall Shielded
- 1-100 conductors (depending on AWG)
- Messenger Galv. or Stainless Steel—External or Internal

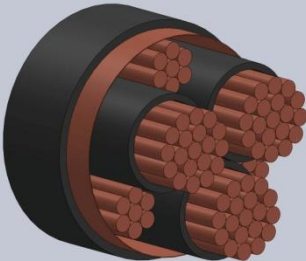

## SHIELDING/TAPES/FILLERS

- Copper, Aluminum Foil
- Fillers – Fibrous & Solid (Non-Hydroscopic)

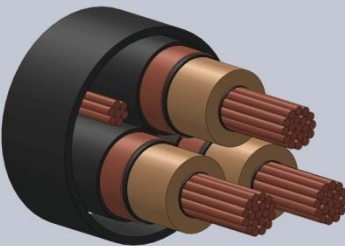

## ARMORING

- Available in Alum. (AIA) or Galv. Steel (GSIA)
- OD up to 4.5"

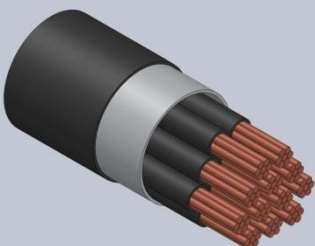

## PHASE IDENTIFICATION

- Color, Stripes, Number, Letter, Legend, Seq. Markings

## VOLTAGE AND TEMPERATURES

- 150V to 30kV
- 40 to 300° C